

REVISION INFO			
DATE	MISC. RD. INFO.	WAGNER / HIDDEN PINES	
07/31/00			
10/31/01			
05/31/02			
01/31/03			
06/09/03			

REVISIONS		
DATE	NAME	LIC. No.
07/31/00	RICHARD A. MORALLE, PLS	25863
10/31/01	RICHARD A. MORALLE, PLS	25863
05/31/02	RICHARD A. MORALLE, PLS	25863
01/31/03	RICHARD A. MORALLE, PLS	6825863
06/30/03	RICHARD A. MORALLE, PLS	6825863
04/15/04	PETER R. AVAKIAN, P.L.S.	2842
01/10/05	PETER R. AVAKIAN, P.L.S.	2842
09/15/05	PETER R. AVAKIAN, P.L.S.	2842
11/22/05	PETER R. AVAKIAN, P.L.S.	2842
10/20/06	PETER R. AVAKIAN, P.L.S.	2842
1/25/08	PETER R. AVAKIAN, P.L.S.	2842
09/11/08	PETER R. AVAKIAN, P.L.S.	2842
01/2/09	PETER R. AVAKIAN, P.L.S.	2842
01/22/10	PETER R. AVAKIAN, P.L.S.	2842
12/29/10	PETER R. AVAKIAN, P.L.S.	2842
1/13/12	PETER R. AVAKIAN, P.L.S.	2842
02/6/13	PETER R. AVAKIAN, P.L.S.	2842
02/25/14	PETER R. AVAKIAN, P.L.S.	2842
02/12/16	PETER R. AVAKIAN, P.L.S.	2842
02/6/17	PETER R. AVAKIAN, P.L.S.	2842
1/26/18	PETER R. AVAKIAN, P.L.S.	2842
1/21/19	PETER R. AVAKIAN, P.L.S.	2842
10/21/19	PETER R. AVAKIAN, P.L.S.	2842
11/12/20	PETER R. AVAKIAN, PLS	2842

**LEGEND**

- ① DETAIL SHEET NUMBER
- ⑦ BLOCK NUMBER
- DETAIL SHEET LIMIT

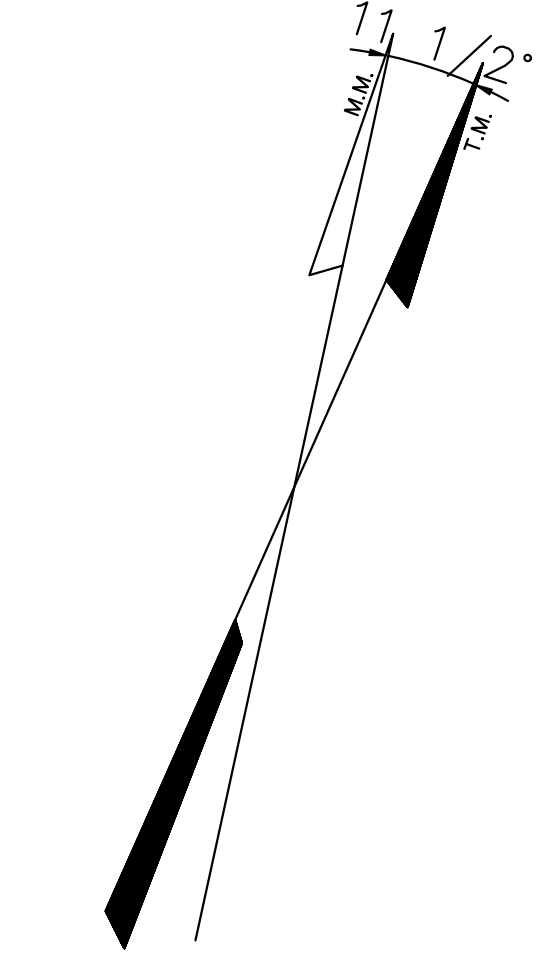
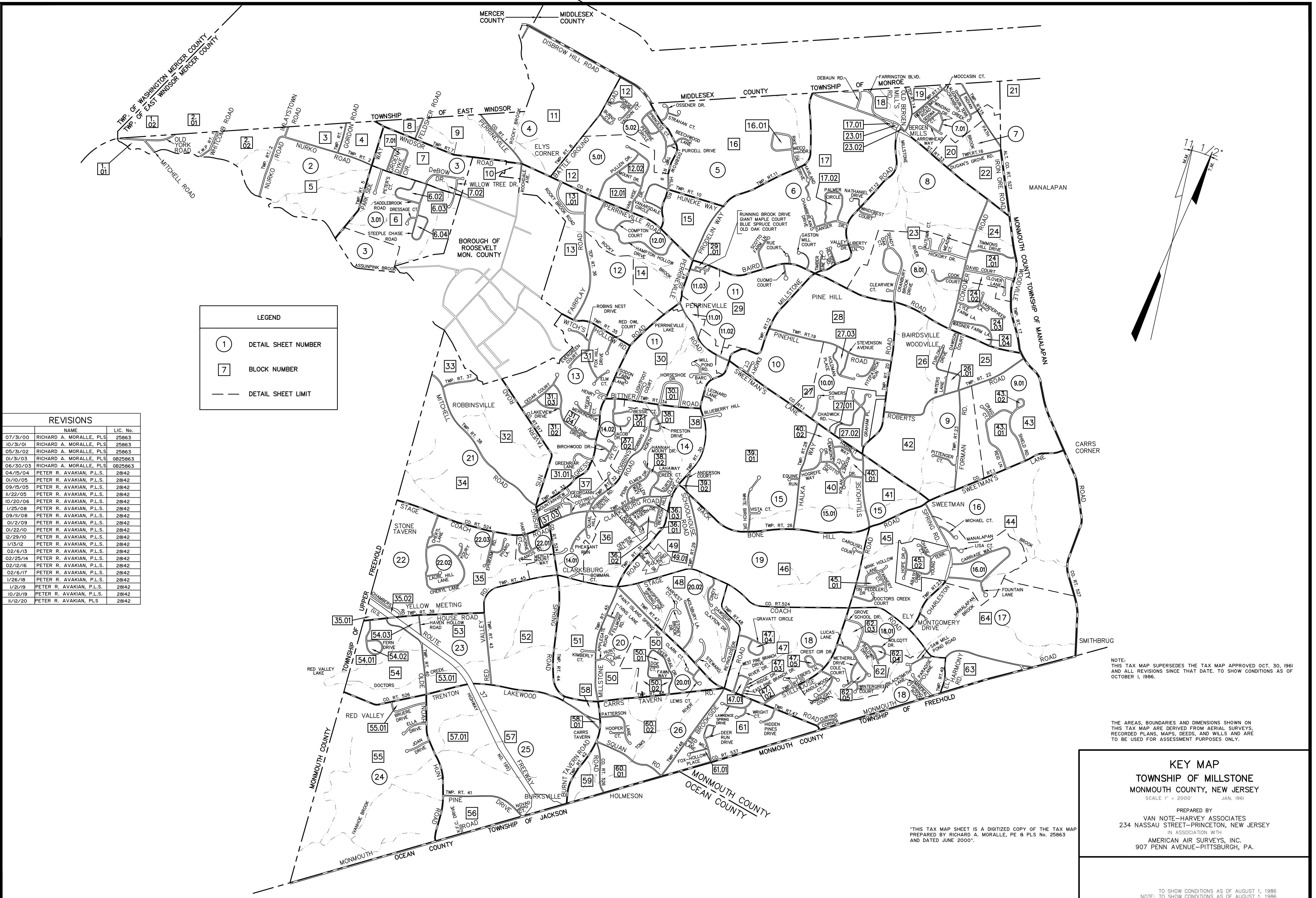

NOTE: THIS TAX MAP SUPERSEDES THE TAX MAP APPROVED OCT. 30, 1961 AND ALL REVISIONS SINCE THAT DATE, TO SHOW CONDITIONS AS OF OCTOBER 1, 1986.

THE AREAS, BOUNDARIES AND DIMENSIONS SHOWN ON THIS TAX MAP ARE DERIVED FROM AERIAL SURVEYS, RECORDED PLANS, MAPS, DEEDS, AND WILLS AND ARE TO BE USED FOR ASSESSMENT PURPOSES ONLY.

**KEY MAP**  
**TOWNSHIP OF MILLSTONE**  
**MONMOUTH COUNTY, NEW JERSEY**  
 SCALE 1" = 2000' JAN. 1961

PREPARED BY  
 VAN NOTE-HARVEY ASSOCIATES  
 234 NASSAU STREET-PRINCETON, NEW JERSEY  
 IN ASSOCIATION WITH  
 AMERICAN AIR SURVEYS, INC.  
 907 PENN AVENUE-PITTSBURGH, PA.

\*THIS TAX MAP SHEET IS A DIGITIZED COPY OF THE TAX MAP PREPARED BY RICHARD A. MORALLE, PE & PLS No. 25863 AND DATED JUNE 2000\*.

TO SHOW CONDITIONS AS OF AUGUST 1, 1986  
 NOTE: TO SHOW CONDITIONS AS OF AUGUST 1, 1986