

WEBSITE NOTICE

- A. Applicant Name: 700 Highway 33, LLC
- B. Application is before the Zoning Board of Adjustment
 Hearing Location: Municipal Meeting Room
 215 Millstone Road
 Millstone Township, NJ 08535
 Time and Date: Beginning at 7:30 p.m. on January 25, 2023
- C. Board Contact Information: Millstone Township Municipal Building
 Land Use Office
 470 Stage Coach Road
 Millstone Township, New Jersey 08510
 Applications can be viewed Mon-Fri, 8:30 a.m.-4:00 p.m.
 or on the Millstone Township Planning/Zoning Board
 website 48 hours prior to the meeting at:
 Zoning: <https://www.millstonenj.gov/boa-agendas-minutes>
 732-446-1936
- D. Place an "X" where applicable:
 Variance(Use) Appeal
 Preliminary Major Subdivision Interpretation
 Preliminary Site Plan (amend) Other (describe) _____
 Final Site Plan
- E. The applicant seeks Amended Preliminary and Final Site Plan and Use Variance approval to permit outdoor display of Xtreme Machines goods, to permit outdoor storage within a fenced area, to amend the restrictions in a prior application relating to signage, to approve the existing signage on the property, to build an accessory storage building and to extend 6 parking spaces to accommodate parking for vehicles and trailers
- F. Include a Key Map

Property Address: 700 Highway 33
 Millstone Township: Block 18, Lot 2.01 and
 Monroe Township: Block 8.01, Lots 2.12 and 2.13
 Application #: Z22-10

Please provide completed Form to the Board Secretary no later than fifteen (15) days prior to the hearing date for posting on the Website (ORD 06-09).

TAX LOT 12.05
(MAKE-A-WISH
FOUNDATION)

TAX LOT 2.09
(VACANT/STORMWATER BASIN)

TAX LOT 2.10
(MONROE TENNIS, BASKETBALL
& SPORTS CENTER)

PERRINEVILLE ROAD
(41.5' WIDE R.O.W.)

EX. CONSERVATION
EASEMENT

EX. SIGHT
TRIANGLE
EASEMENT

EX. UTILITY
EASEMENT

EX. CONSERVATION
EASEMENT

EX. R.O.W.
EASEMENT

EX. CONSERVATION
EASEMENT

BLOCK 8

EX. DRAINAGE
EASEMENT

EX. DRAINAGE
EASEMENT

EX. DRAINAGE
EASEMENT

BLOCK 6

EX. CONSERVATION
EASEMENT

BLOCK 8.01
TAX LOT 2.12

TAX LOT 8.04
(VACANT)

TAX LOT 2.02
(VACANT)

EX. D.R.C.C.
CORRIDOR
BUFFER
EASEMENT

EX. CONSERVATION
EASEMENT

EX. DRAINAGE
EASEMENT

EX. DRAINAGE
EASEMENT

FARRINGTON BOULEVARD
(70' WIDE R.O.W.)

TAX LOT 13.01
(VACANT)

BLOCK 8.01
TAX LOT 2.13

MONROE TOWNSHIP - MIDDLESEX COUNTY
MILLSTONE TOWNSHIP - MORMOUTH COUNTY

TAX LOT 8.03
(VACANT)

BLOCK 18
TAX LOT 2.01

TAX LOT 8.02
(VACANT)

HD ZONE

PCD ZONE

TAX LOT 1.01
(BAKER'S AMERICAN
BAR & GRILL)

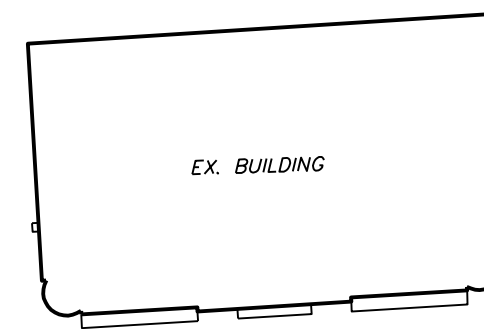

TAX LOT 2.02
(VACANT)

TAX LOT 10
(VACANT)

200' Radius (Typ.)

TAX LOT 1

AREA MAP

SCALE: (1 Inch = 100 Feet)

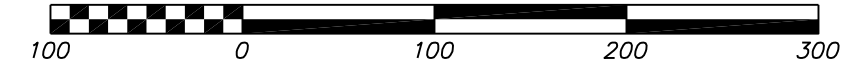

NEW JERSEY STATE HIGHWAY ROUTE No. 33
(123' WIDE R.O.W.)

PCD ZONE

HD ZONE

TAX LOT 3

TAX LOT 4
(RESIDENTIAL)

TAX LOT 5
(RESIDENTIAL)

BLOCK 17

TAX LOT 6
(VACANT)